

GRANVILLE[®]

AT RIVERSTONE

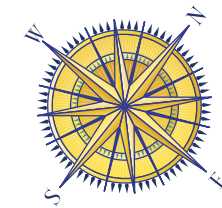
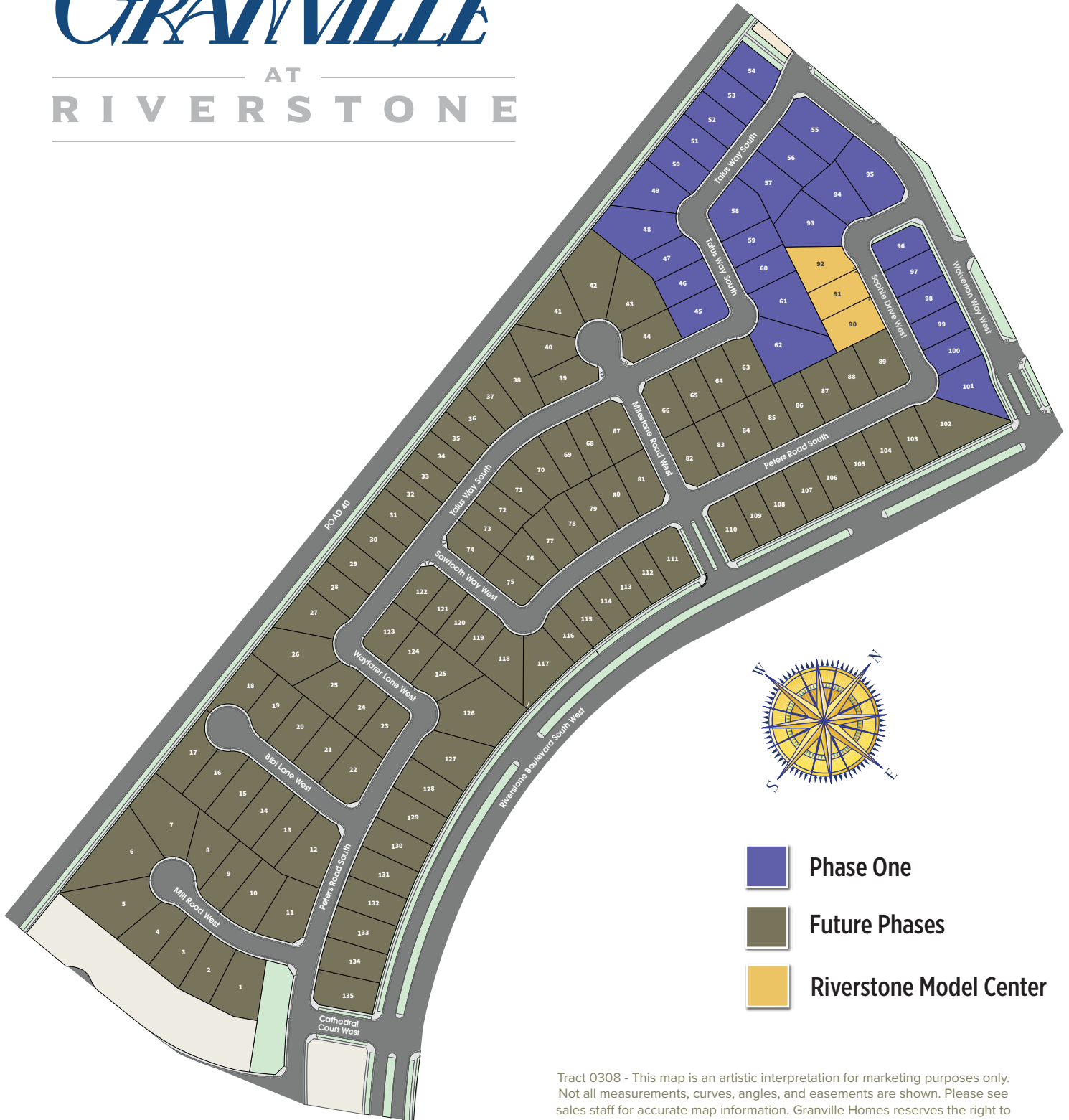

- Phase One
- Future Phases
- Riverstone Model Center

Tract 0308 - This map is an artistic interpretation for marketing purposes only. Not all measurements, curves, angles, and easements are shown. Please see sales staff for accurate map information. Granville Homes reserves the right to alter maps, plans and availability without notice or obligation.



RIVERSTONE

MAP + PARTIAL LIST OF AMENITIES



- | | | |
|-------------------------|---------------------|----------------------|
| 1. The Lodge | 4. Future Retail | 7. Dog Park |
| 2. Adventure Park | 5. Future Offices | 8. Community Trail |
| 3. Retail & Restaurants | 6. Riverstone Farms | 9. Elementary School |

Riverstone also includes over 200 acres of local and regional parks, recreation centers and access to open space reserves along the San Joaquin River.

Information shown is based on current and future amenities as provided by the Riverstone Marketing team. Map is an artist rendering and may not accurately represent measurements, landmarks and features. Granville Homes makes no guarantees to the accuracy of the information presented on this map. For most current and accurate information, please speak with a Granville sales representative.

559.445.9000 | gvhomes.com

RE License # 01258537 Contractor License #586845



GRANVILLE
HOMES